

of

a subdivision located in the Southeast 1/4 of Section 6, Town 1 North, Range 17 East, Village of Williams Bay, Walworth County, Wisconsin.

P.O. Box 490
Williams Bay, Wisconsin. 53191

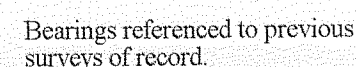

- 1) This survey plat is not certified unless signed and sealed in red ink.
- 2) This survey is subject to Wisconsin lien laws. This Plat of Survey is the notice of intent to file lien. Lien waiver required.

All rights reserved. No part of this survey plat may be reproduced or transmitted in any form by any means - graphic, electronic, or mechanical, including photocopying, tracing, or information storage and retrieval systems - without permission in writing from Douglas G. Olson, Jensen & Olson Land Surveying, LLC.

Douglas G. Olson
Wisconsin Registered Land Surveyor - 2093

Scale in Feet
1" = 20'

A horizontal scale bar with alternating black and white segments. It is marked with '0', '10', '20', and '40' at regular intervals.

Legend

- Legend
- | | |
|----|----------------------------|
| ■ | Found Concrete Monument |
| ○ | Found Iron Pipe |
| ● | Found Iron Rod |
| ○ | Set Iron Rod, 3/4" dia. |
| () | Recorded Information |
| ⊗ | Utility Pole ⊕ Water valve |
| ▨ | Asphalt Surface |
| ▩ | Concrete Surface |
| ▩ | Gravel |

Sheet 1 of 1 Sheets

Job Reference Number

2009.071

011-2279